



**Easy to Install. Built to Last.**



**Fits all Panels.**

## Rayport™ Stainless Series Roof Ballast Rack

### Benefits

The ONLY stainless steel roof ballast system available on the market

Industry-leading installation time

Fits all panels available on the market today

Top-down assembly of PV panels

Racks include integrated fasteners allowing one common bolt for all joints

Wind tunnel tested to 120mph

Grounding (rack): 1 grounding lug per tray to be installed at the rear support rail (every 20 rows)

Only 4 part numbers to order

No cutting or drilling required

Full layout and loading analysis for every project

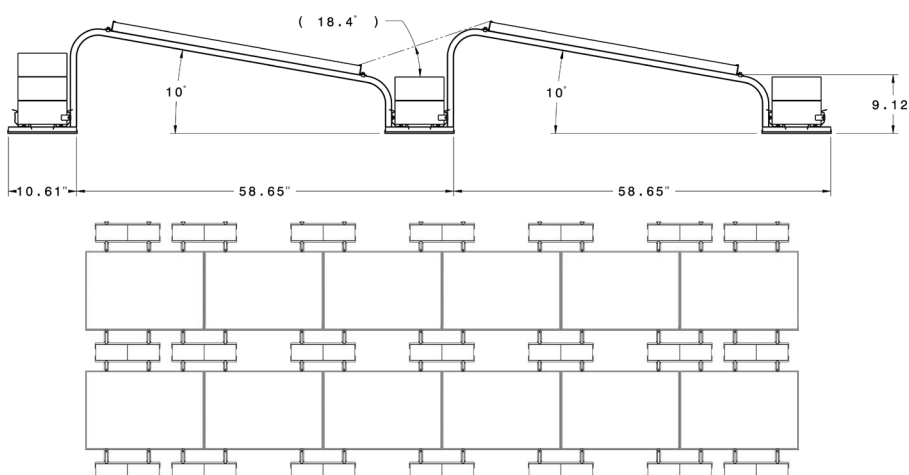

### Engineered Solutions for Renewable Energy Systems

**AET products are design-driven**  
— a perfect integration of form and function.

QTY	ITEM	PART NAME
2	1	SUPPORT RAIL - ASM
1	2	BALLAST TRAY - ASM
4	3	CLAMP - MODULE
8	4	SCREW - 1/4-20

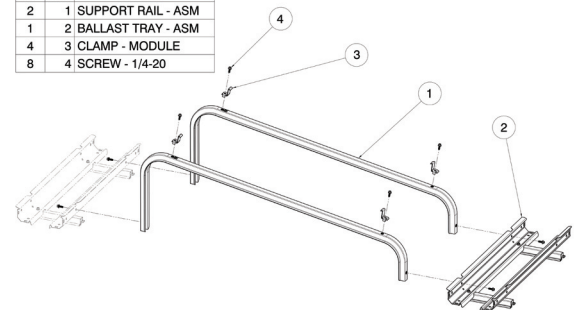

### Specifications

Panel-to-panel length: 1489 mm (58.65 in)

Panel angle: Angle available from 0 to 30 degrees

Panel layout: Landscape

Panel height from roof: 232 mm (9.12 in)

Contact surface: EPDM feet

System Dead Load: As low as 5 psf

Warranty: 15-Yr Limited Warranty